

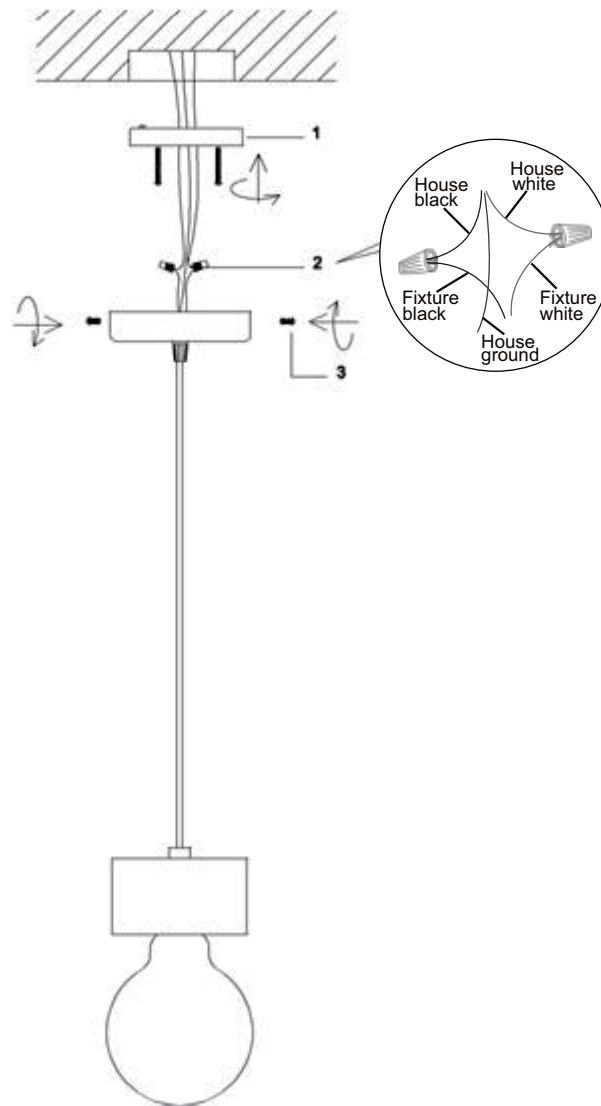

C56602WH



INSTALLATION INSTRUCTIONS:

- Ensure main supply is switched of
- Fit mounting bracket (1) onto mounting surface with self-tapping screws .
- Connect wires (2) according to color (White to White, Black to Black). Connect all earth lug together onto the crossbar with green screw to tight.
- Fit ceiling plate onto mounting bracket with screws (3).
- Install lamps firmly into lampholders.
- Reconnect power.

WARNING:

- This fitting must be earthed.
- Disconnect power and allow fitting to cool down before cleaning or changing the lamp.